

ASTON

LANE COVE

Development Complete
5th May 2016

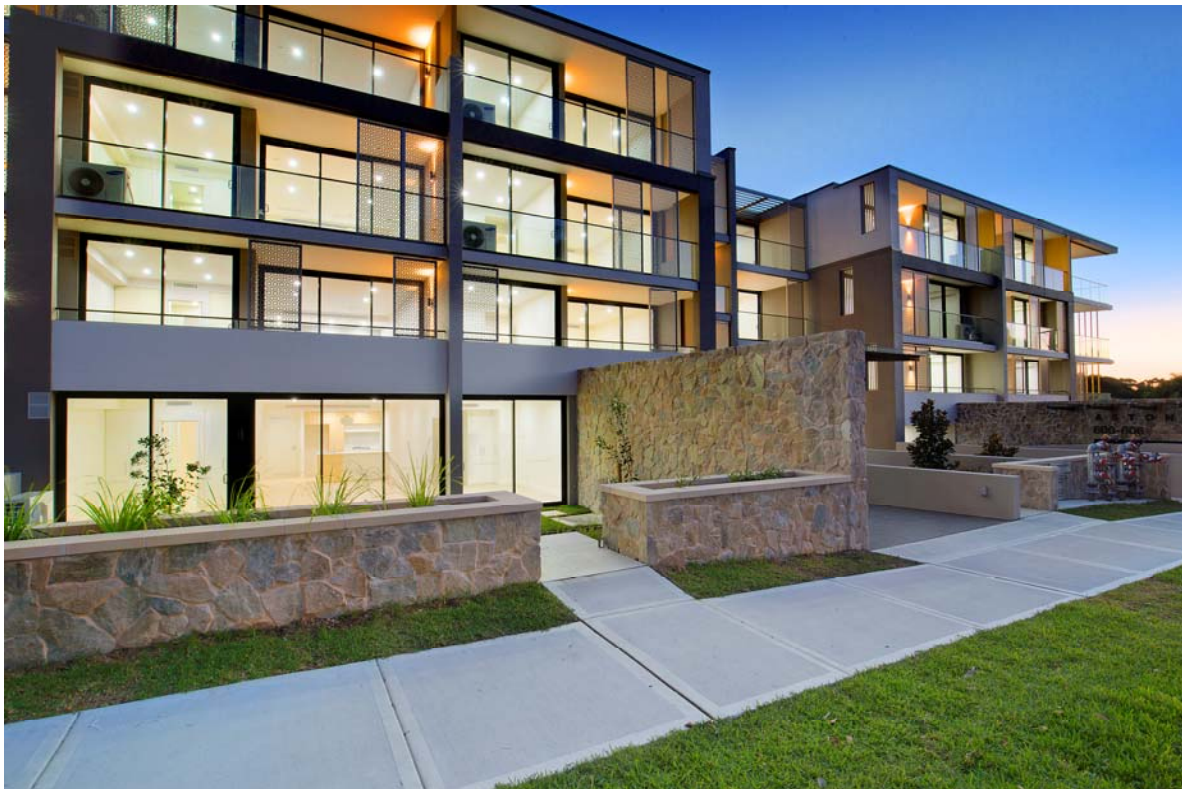

ASTON – The next Generation of Apartment Living

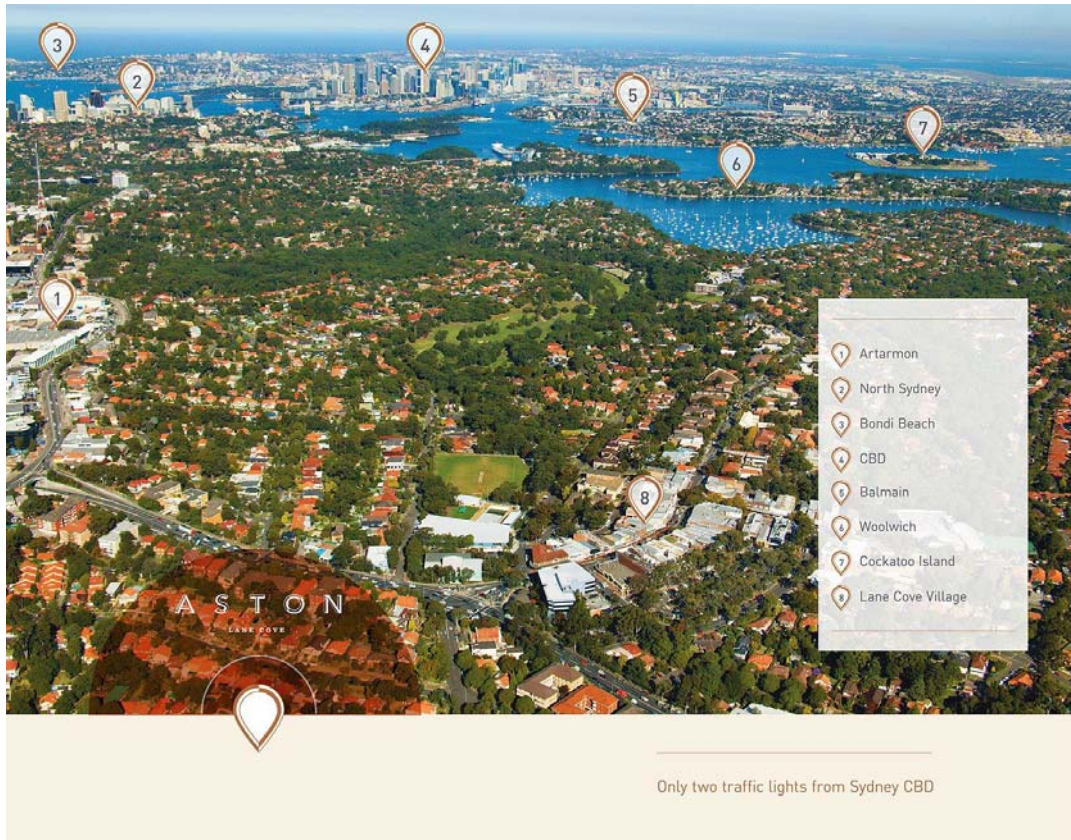

Aston Apartments has set the benchmark in apartment living.

This elevated North facing development will be a contemporary building while connecting you with everything the local area has to offer. Lane Cove is predicted to become one of Sydney's most strategic locations.



The Locals Map

- | | | | |
|--------------------------------------|-----------------------------------|------------------------|---------------------------|
| 1 Burns Bay Reserve | 5 Chatswood Train Station | 9 Aquatic Centre | 13 Lane Cove Library |
| 2 Lane Cove National Park | 6 Chatswood Chase Shopping Centre | 10 Pottery Green Park | 14 Pablo & Rusty's |
| 3 Chatswood Golf Course | 7 Westfield Chatswood | 11 Via Napoli Pizzeria | 15 Hudson Meats |
| 4 The Concourse Entertainment Venues | 8 Cafe New York | 12 Thomas Dux | 16 Artarmon Train Station |
| | | | 17 Batten Reserve |

Lane Cove is a lively, safe and friendly community nestled in and around the greenery of nearby National Park and Batten Reserve. Get back to nature by hiking the various bush walking tracks, cycling the parkways or leisurely rowing along the Burns Bay Reserve.

It is only a short commute from the business hub of Lane Cove West Business Park, Macquarie Park and only two traffic lights from Sydney CBD. Aston is minutes from browsing boutique shops and eateries of Chatswood Chase or enjoying the Sydney CBD.

Keen swimmers are only a short distance to Lane Cove Aquatic Centre or if you prefer the outdoors, the Tennis World Club in Lane Cove and the Chatswood Golf Course are both close by.





